



HYDROMATIC®

Pentair Water

Complete Grinder Package Offering

**NEW
TL-Pro
System**

Package includes your choice of a 2HP submersible grinder pump, TL-Pro or TG-Pro lift out system, control panel, three floats and a fiberglass basin with anti-floatation collar.



Our complete grinder package is a proven, innovative solution to a changing world



The use of grinder pumps prove to be a superior solution that is cost effective and minimally disruptive to the natural environment.

Submersible Grinder Pumps keep beauty in the environment and cash in the pocket



A grinder pump based system can be installed using relatively small diameter piping (as small as 1-1/4" to 2" laterals and mains), which can be laid in shallow trenches. Since the wastewater is pumped under low pressures, the piping can follow the terrain and be installed at minimal depths (just under the frost line in colder climates and according to local codes). Cost savings come from the ability to eliminate costly deep excavation and through the use of small diameter pipe. Minimal excavation and soil disruption means that the beauty of any existing natural surrounding features can be saved.



- Grinder Pump System
- Service Connection
- Pressure Sewer Connection Line

About Hydromatic

A national leader in the wastewater pump industry for over 45 years. Hydromatic represents one of the most diversified lines of submersible sump, sewage, effluent, grinder pumps, large non-clog pumps and self primers for the municipal, industrial, commercial, residential domestic and international markets.

Located in Ashland, Ohio, USA, Hydromatic was acquired by Pentair, Inc. (NYSE: PNR) in August of 1997 and today is part of Pentair Water.

Our Mission... to provide extraordinary responsive service and superior quality products so that our customers find it easy to do business with us.



TG-Pro System

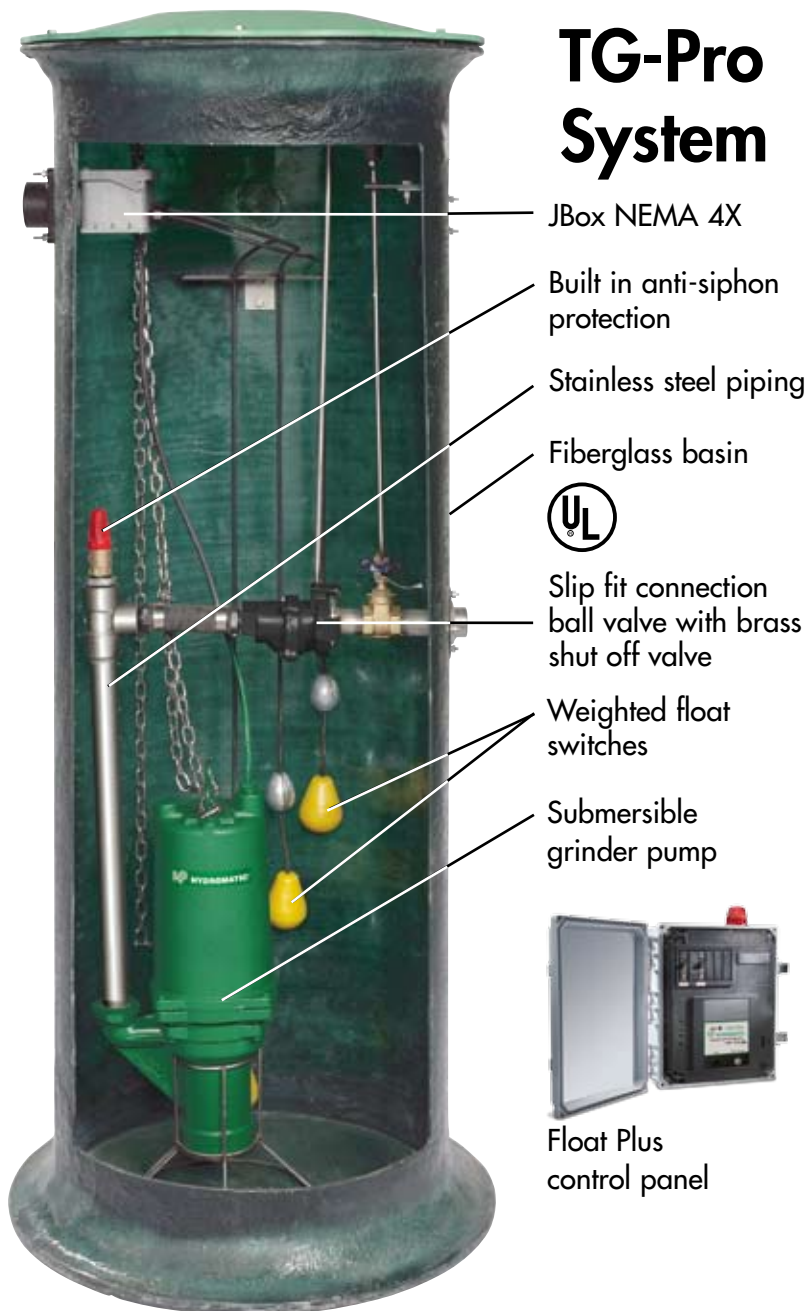



Easy slip fit connection allows for quick installations and servicing

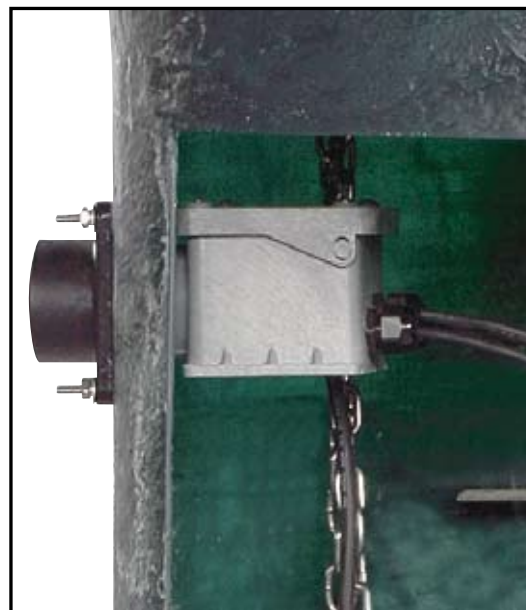

Heavy duty 1-1/4" flexible pipe



No hard-wiring to junction box required with optional quick disconnect

Choose Your Pump	
	HPD200 Submersible Semi-Positive Displacement Grinder Pump
	HPG200 Submersible Centrifugal Grinder Pump
	HPGR200 Centrifugal Automatic Grinder Pump

NEW

TL-Pro System

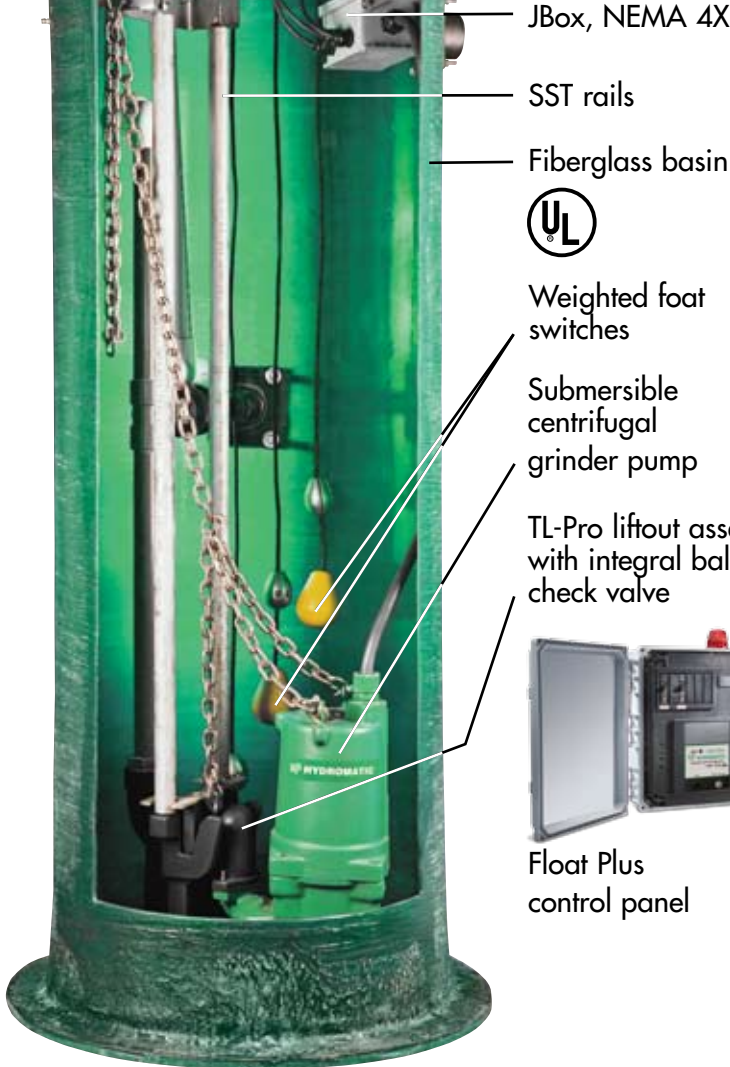

JBox, NEMA 4X

SST rails

Fiberglass basin



Weighted float switches

Submersible centrifugal grinder pump

TL-Pro liftout assembly with integral ball check valve



Float Plus control panel



Stainless steel brackets ensure parts will not corrode



TL-Pro liftout valve with integral ball check valve



Heavy duty construction

Choose Your Pump



HPG200
Submersible Centrifugal Grinder Pump



HPGX200
Submersible Centrifugal Grinder Pump



HPGR200
Submersible Centrifugal Grinder Pump



**Centrifugal
 Grinder
 Pump**





**Centrifugal
 Grinder
 Pump**

HPG200

- Semi-open impeller provides steep non-overloading operating curve.
- Durable motor will deliver many years of reliable service.
- Oil-filled motor for maximum heat dissipation and constant bearing lubrication.
- Exclusive dual cutter design cuts solids to the smallest particle size.
- High torque capacitor start/run for assured starting under heavy load.

HPGR200

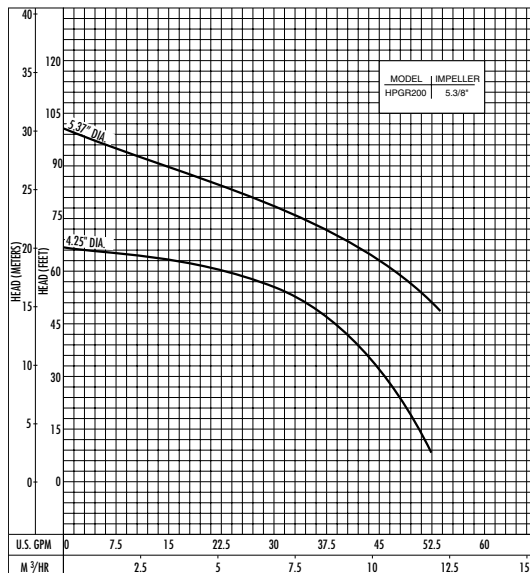
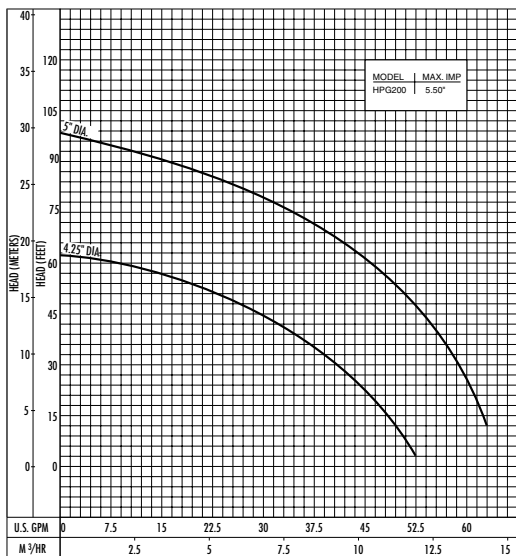
- Semi-open impeller provides steep non-overloading operating curve.
- Durable motor will deliver many years of reliable service.
- Oil-filled motor for maximum heat dissipation and constant bearing lubrication.
- Shredding ring and grinder impeller are replaceable without dismantling pump or motor.





CSA **FM**
APPROVED
**Centrifugal
Grinder Pump**

HPGX200

- Explosion proof option
- Class 1, Division 1, Groups C&D
- Dual seals for maximum moisture protection.
- Oil-filled motor for maximum heat dissipation and constant bearing lubrication.
- Exclusive dual cutter design cuts solids to the smallest particle size.
- Semiopen impeller provides steep non-overloading operating curve.

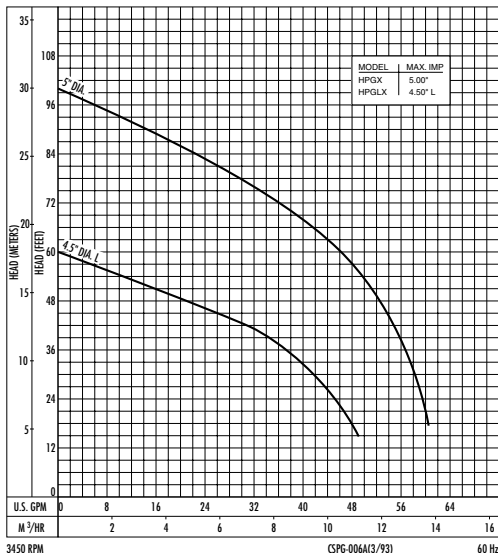

CSA
**Semi-Positive
Displacement
Grinder Pump**

HPD200

- Available in either 1750 RPM at 60Hz or 1460 RPM at 50Hz
- CSA Approved
- 1-1/4 inch NPT discharge pump with a vertical discharge that conquers capacities up to 17-1/2 gallons per minute and heads up to 220 feet.

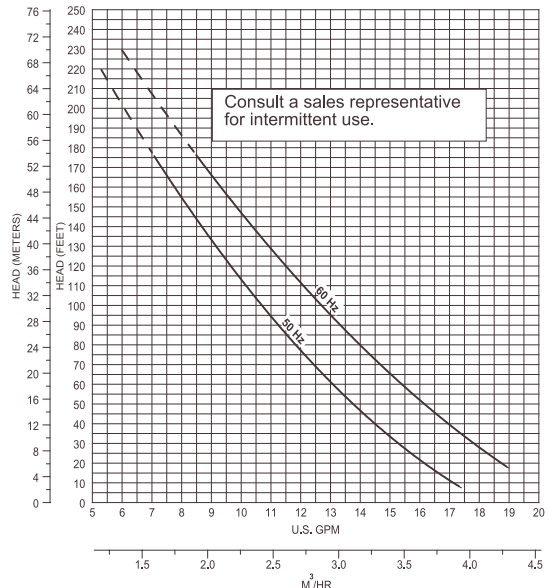



SUBDOOR CONTROL CENTER



Alarm Circuit Power Light

Test/Silence Pushbutton

Alarm Light

Hand Run Switch

Pump Run Light

PLUS SERIES FLOAT SYSTEMS

The Float Plus Series is an innovative approach to today's pump control system requirements with standard features unmatched by most competitors. Through the use of a standard subdoor and raised backpanel, the Float Plus Series offers a revolutionary design for housing common control panel features such as circuit breakers, start components, contactors and a terminal strip. While others ask you for more dollars to cover options, the Float Plus Series provides many of the most requested items as standard equipment. Some of these standard features include lockable latches, a flashing red alarm light with an electronic horn, the innovative touch to silence pad, and a control circuit board, all in a NEMA 4X enclosure. In addition to unsurpassed standard features, Float Plus offers an exclusive control circuit board.

TYPICAL SIMPLEX FLOAT INSTALLATION



SPECIFICATIONS

Available in Simplex	
Enclosure Dimensions	12.5" x 12" x 7.5"
Overall Dimensions	14.5" x 12" x 7.5"
Enclosure	Nema 4X with molded mounting feet
Alarm Piezo	95 db with "Touch to Silence" circuitry
Flashing Red Alarm Beacon	Provides 360° Visual Display
Weight	10.8 lbs.
25 amp "DP" Heavy Duty Definite Purpose Contactors	
Nonconductive Injection Molded Subdoor	
Blown Fuse Status Lights	
cULus 508 Listed	
Requires three float switches for simplex.	

Hydromatic SYSTEM OPTIONS for TL-Pro LPS Systems

Optional Covers/Lids

Solid fiberglass diamond plate and aluminum covers available with access hatch. Consult a Hydromatic sales representative.

Optional 2" Mushroom Vent

Weather resistant with screen vent.

Optional Basin Diameters

Consult a Hydromatic sales representative.

Optional Basin Depths

Consult a Hydromatic sales representative.

Optional Explosion- Proof Rail Package

Brass and spark-free system utilizing HPGX pump and TL-Pro system. Consult a Hydromatic sales representative.

CONTROL OPTIONS

Optional Seal Fail Alarm

Available with dual seal pumps only.

Optional Thermal Overload Alarm

Optional Intrinsically Safe Control Box

Warranty

Hydromatic Pump, Inc. warrants to the original purchaser of each Hydromatic product(s) that any part thereof that proves to be defective in material or workmanship within one year from date of installation or 18 months from manufacture date, whichever comes first, will be replaced at no charge with a new or remanufactured part, F.O.B. factory. Purchaser shall assume all responsibility and expense from removal, reinstallation and freight. Any item(s) designated as manufactured by others shall be covered only by the express warranty of the manufacturer thereof. This warranty does not apply to damage resulting from accident, alteration, design, misuse or abuse. The pump must be installed, operated and maintained in accordance with the published instructions of the appropriate Installation & Service Manual.

All dual seal nonclogs and 3-5 HP grinders must have seal failure and heat sensors attached and functional for Warranty to be in effect. If a seal failure should occur, Hydromatic Pump will cover only the lower seal and labor thereof. Labor is based on Authorized Service Center contract allowance. If the heat sensor is not attached and functional, Warranty is void. If the seal failure sensor is not attached and functional, Warranty is void. If the material furnished to the Buyer shall fail to conform to this contract or to any of the terms of this written warranty, Hydromatic Pump, Inc. shall replace such nonconforming material at the original point of delivery and shall furnish instruction for its disposition. Any transportation charges involved in such disposition shall be for the Buyer's account. The Buyer's exclusive and sole remedy on account or in respect of the furnishing of material that does not conform to this contract or to this written warranty, shall be to secure replacement thereof as aforesaid. Hydromatic Pump, Inc. shall not in any event be liable for the cost of any labor expended on any such material or for any incidental or consequential damages to anyone by reason of the fact that such material does not conform to this contract or to this written warranty.

ALL IMPLIED WARRANTIES, INCLUDING THE IMPLIED WARRANTY OF MERCHANTABILITY AND THE IMPLIED WARRANTY OF FITNESS FOR A PARTICULAR PURPOSE, ARE DISCLAIMED TO THE SAME EXTENT AS THE EXPRESS WARRANTY CONTAINED HEREIN. Some states do not allow limitations on how long an implied warranty lasts, so the above limitation may not apply to you. MANUFACTURER EXPRESSLY DISCLAIMS AND EXCLUDES ANY LIABILITY FOR CONSEQUENTIAL OR INCIDENTAL DAMAGES FOR BREACH OF ANY EXPRESS OR IMPLIED WARRANTY ARISING IN CONNECTION WITH THIS PRODUCT, INCLUDING WITHOUT LIMITATION, WHETHER IN TORT, NEGLIGENCE, STRICT LIABILITY CONTRACT OR OTHERWISE. Some states do not allow the exclusion or limitation of incidental or consequential damages, so the above limitation or exclusion may not apply to you. This warranty gives you specific legal rights, and you may also have other rights which vary from state to state.

 HYDROMATIC® Pentair Water USA 740 East 9th Street Ashland, Ohio 44805 Tel: 419-289-3042 Fax: 419-281-4087 www.hydromatic.com	- Your Authorized Local Distributor -
	CANADA 269 Trillium Drive Kitchener, Ontario, Canada N2G 4W5 Tel: 519-896-2163 Fax: 519-896-6337

Performance Curve HPD200

RPM: 1725 60Hz or 1460 50Hz Discharge: 1-1/4"

Page: 1, Model: HPD200
Complete Grinder Package Offering

Dated: October 2005
Supersedes: October 2000
Page101A

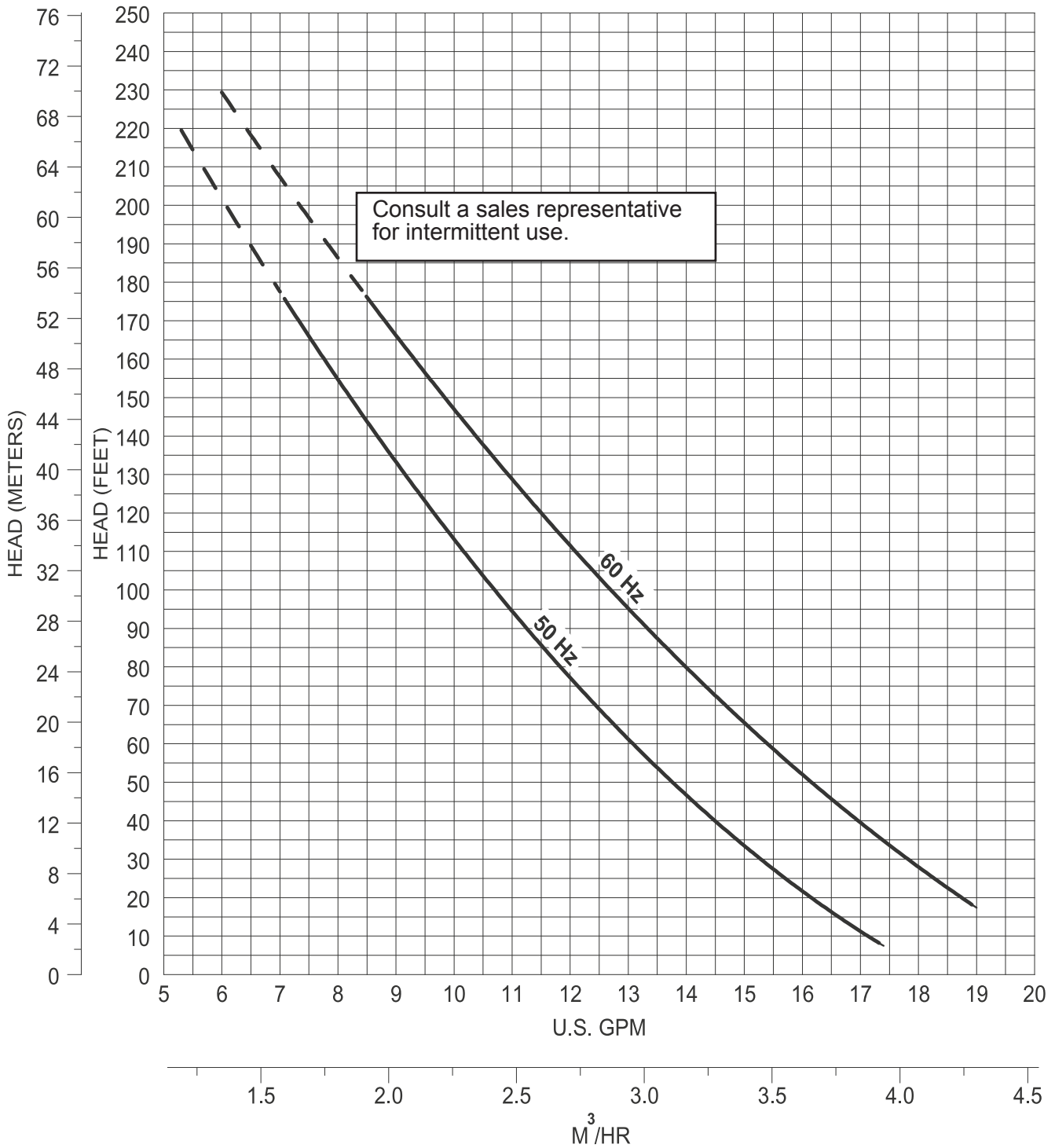

The curves reflect maximum performance characteristics without exceeding full load (Nameplate) horsepower. All pumps have a service factor of 1.2. Operation is recommended in the bounded area with operational point within the curve limit. Performance curves are based on actual tests with clear water at 70° F. and 1280 feet site elevation.



Conditions of Service:

GPM: _____ TDH: _____

Dimensional Data

HPD200

Page: 2, Model: HPD200
 Complete Grinder Package Offering

Dated: October 2005
 Supersedes: December 2002
 Page 201A

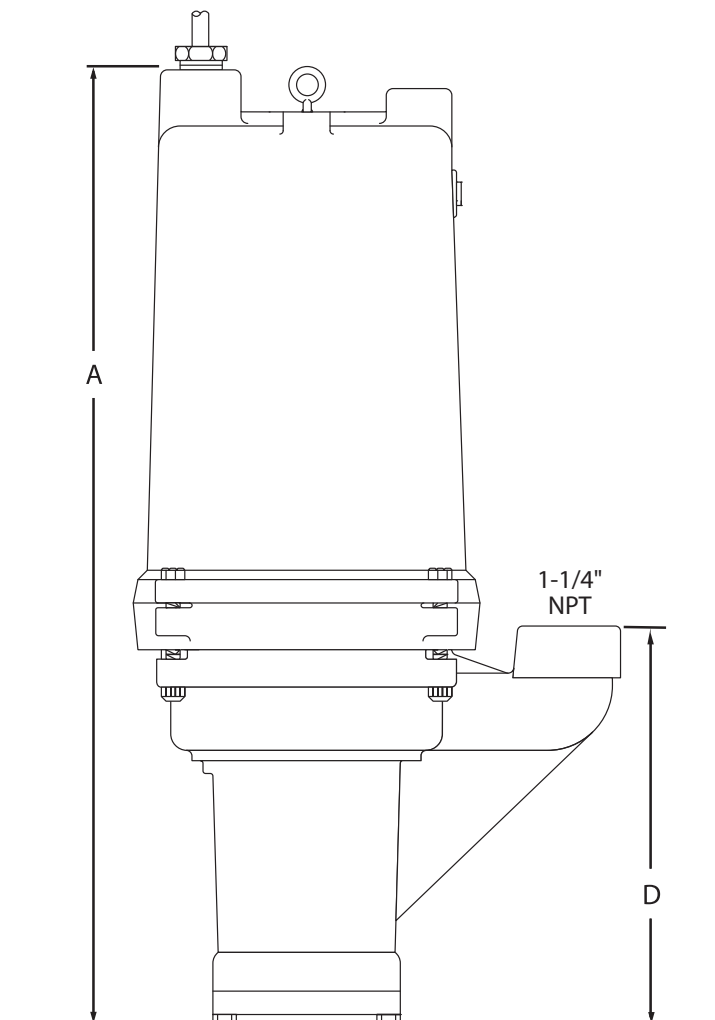
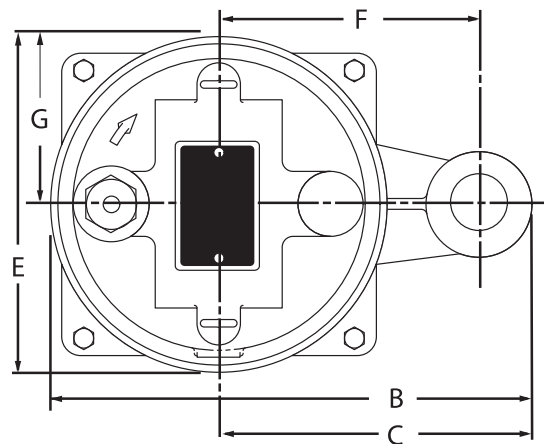

	A	B	C	D	E	F	G
HPD200	22-1/4	10-1/2	7-1/4	9-1/8	6-19/32	6	3-5/16

Electrical Data

HPD200

Page: 3, Model: HPD200
Complete Grinder Package Offering

Dated: October 2005
Supersedes: December 2002
Page 301A

R.P.M.	1750 (60Hz) and 1460 (50Hz)
MOTOR TYPE	ENCLOSED, OIL COOLED INDUCTION, CAP START; CAP RUN
MOTOR DESIGN NEMA TYPE	A (1 \emptyset)
GENERAL INSULATION CLASS	B
STATOR WINDING CLASS	F
MAXIMUM STATOR TEMPERATURE	130°C
VOLTAGE TOLERANCE	±10%

HP	VOLTAGE	PHASE	NEC CODE	SF	FULL LOAD AMPS	RUN KW	START KVA	RUN KVA
2	230	1	D	1.0	8.0	-	3.90	1.40

MODEL: HPD200 - Submersible Positive Displacement Grinder Pump**Physical Data:**

DISCHARGE SIZE	1¼" NPT
PUMPING STATOR	BUNA-N; DOUBLE HELIX
PUMPING ROTOR	300 SERIES SST; SINGLE LOBE
CABLE LENGTH	20' STANDARD
PAINT	PAINTED AFTER ASSEMBLY. DARK GREEN, ENAMEL, ONE COAT, AIR DRIED.

Temperature:

MAXIMUM LIQUID	140°F
MAXIMUM STATOR	266°F
OIL FLASH POINT	390°F
HEAT SENSOR	Open: 257°F MAX./239°F MIN. Closed: 194°F MAX./149°F MIN.

Technical Data:

POWER CORD TYPE	SJOW/SJOW-A WATER RESISTANT 600V, 60°C, CSA APPROVED	
MATERIALS OF CONSTRUCTION	MOTOR HOUSING	CAST IRON ASTM A-48 CLASS 30
	CASING	CAST IRON ASTM A-48 CLASS 30
	CUTTERS	Stationary: 440C STAINLESS STEEL HARDENED TO 55-60 ROCKWELL C Lower (Radial): 440C STAINLESS STEEL HARDENED TO 55-60 ROCKWELL C
	MOTOR SHAFT	416 STAINLESS STEEL
	HARDWARE	303 SERIES STAINLESS STEEL
	"O" RINGS	BUNA N
MECHANICAL SEALS	Standard: SINGLE CARBON/CERAMIC/BUNA-N, TYPE 2100	
UPPER BEARING	(RADIAL) SINGLE ROW BALL 6203	
LOWER BEARING	(THRUST) SINGLE ROW BALL 6306	
MIN. B-10 BEARING LIFE	50,000 Hrs	

Duplex version
available upon
request.

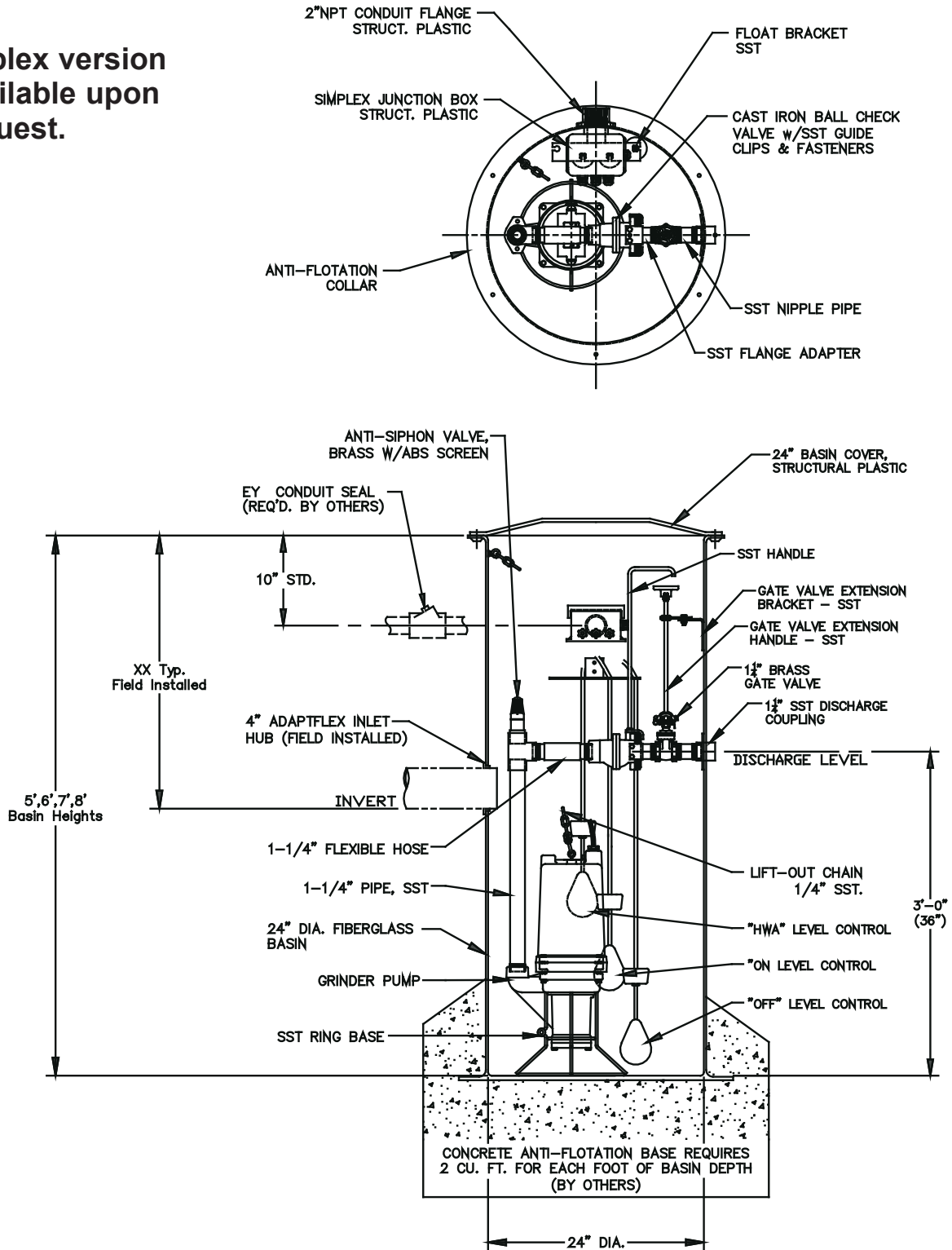

**Specification
Data** **HPD200
TG-Pro System**

Page: 6, Model: HPD200
Complete Grinder Package Offering

Dated: October 2005

To obtain specification, consult your Hydromatic distributor or sales representative.